



Kingfisher Way, London, NW10 8TZ

Offers In Excess Of £250,000 Leasehold



**KEY FEATURES:**

- LEASEHOLD
- STYLISH 7% ROI
- 1 BEDROOM
- 1 BATHROOM
- 1 RECPTION
- 1 PARKING
- GREAT LOCATION

CALLING INVESTORS @7% ROI OR 1ST TIME BUYERS

Welcome to this charming property located at Kingfisher Way in the heart of Neasden, London. This delightful flat is perfect for first-time buyers, downsizers or investors looking for a stylish and well-decorated apartment with loads of storage and a great investment.

Situated on the second floor of a purpose-built building, this property boasts a cosy reception room, ideal for relaxing or entertaining guests. With one bedroom and one bathroom, this flat offers a comfortable living space of 402 sq ft, providing ample room for your daily activities.

The interior of this flat is tastefully decorated, creating a warm and inviting atmosphere that is ready for you to make it your own. Whether you are looking to unwind after a long day or host a gathering with friends, this property offers the perfect backdrop for your lifestyle, also includes 1 x PARKING.

Contact us today to arrange a viewing and take the first step towards making this charming property your new home.

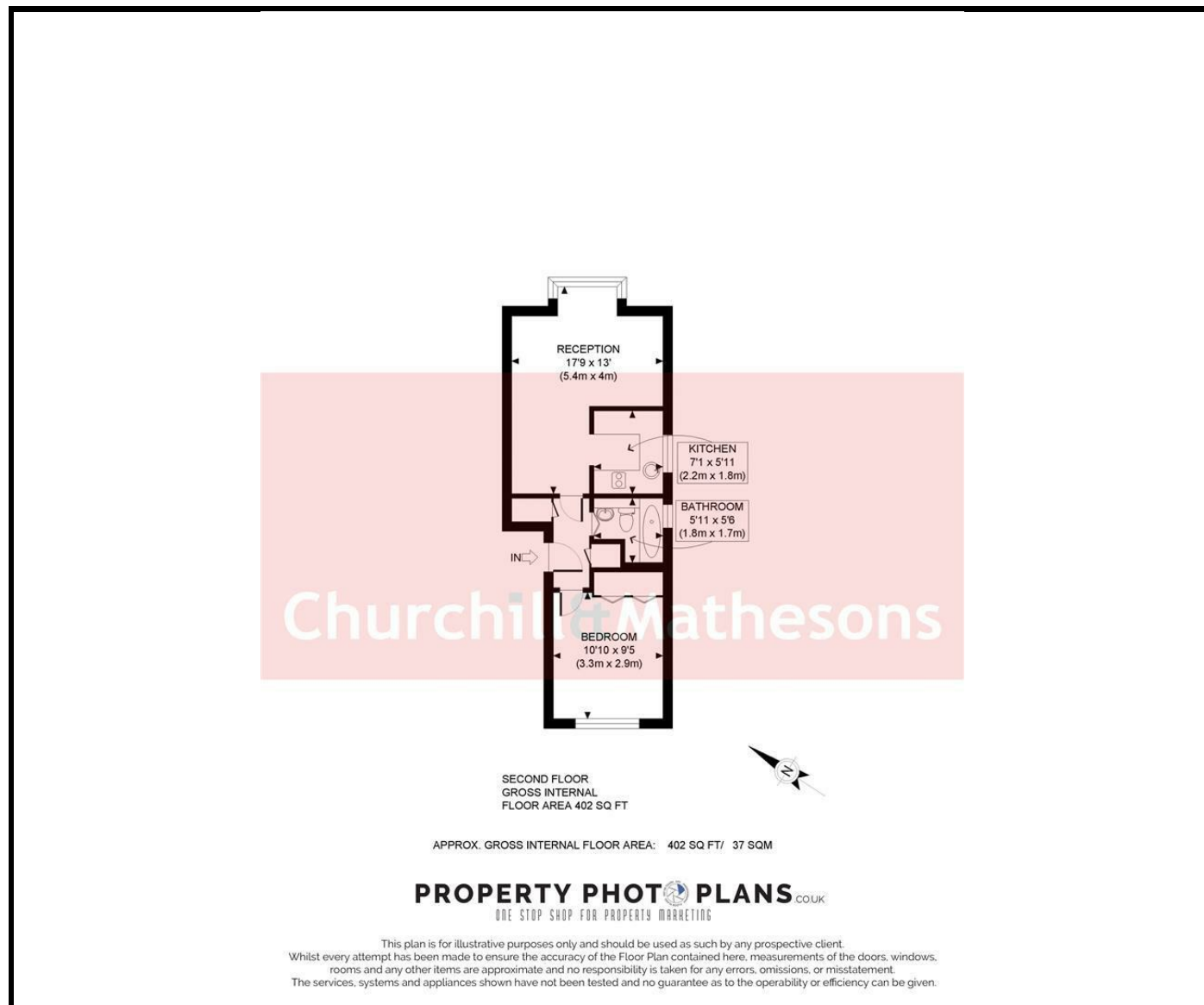

### Energy Efficiency Rating

	Current	Potential
Very energy efficient - lower running costs		
(92 plus) <b>A</b>		
(81-91) <b>B</b>		
(69-80) <b>C</b>		
(55-68) <b>D</b>		
(39-54) <b>E</b>		
(21-38) <b>F</b>		
(1-20) <b>G</b>		
Not energy efficient - higher running costs		

**England & Wales** EU Directive 2002/91/EC

### Environmental Impact (CO<sub>2</sub>) Rating

	Current	Potential
Very environmentally friendly - lower CO <sub>2</sub> emissions		
(92 plus) <b>A</b>		
(81-91) <b>B</b>		
(69-80) <b>C</b>		
(55-68) <b>D</b>		
(39-54) <b>E</b>		
(21-38) <b>F</b>		
(1-20) <b>G</b>		
Not environmentally friendly - higher CO <sub>2</sub> emissions		

**England & Wales** EU Directive 2002/91/EC

Whilst every effort is made to give a fair description, the accuracy of these particulars is not guaranteed, neither do they constitute an offer or contract.

**CHURCHILL & MATHESONS ESTATE AGENTS** have not tested any apparatus, equipment, fitting or services and so cannot verify that they are in working order. The buyer is advised to obtain verification from their solicitor or surveyor. Measurements are correct to within +/- 6 A sonic tape is used. None of the statements contained in these particulars or any of our properties are to be relied upon as a representation of fact.